

Enhancing Sports Facilities at Main Campus & SAN Campus

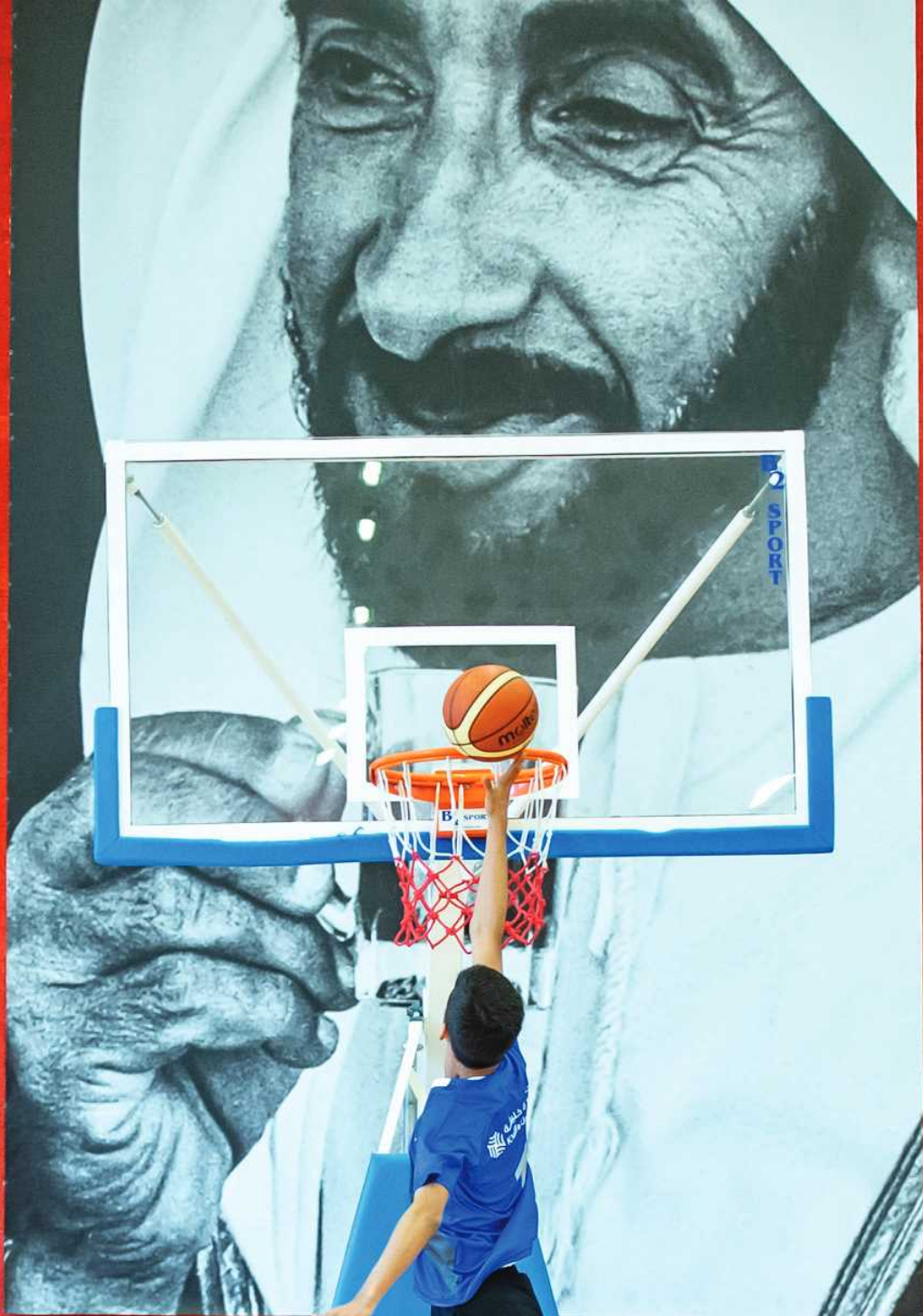



MAIN CAMPUS



MULTIPURPOSE SPORTS HALL

D BUILDING, LEVEL 4

The Multipurpose Sports Hall is a central hub for various sports, including volleyball, basketball, individual rackets, and taekwondo. A comprehensive reevaluation aims to create an inclusive and efficient environment, accommodate male and female students in diverse sports, and foster a dynamic sports culture within our university.



PROPOSED ENHANCEMENTS

A. Multi-Court Configuration

- Modular Court System
- Floor Replacement

B. Innovation Design Features

Ceiling-Mounted System.

- Partitions/Nets.
- Retractable Bleachers.
- Lighting.
- Padded Wall.

C. Additional Spaces

- Track Area.
- Martial Arts Space.
- Changing Room & Shower Facilities



POTENTIAL SPORTS

A modular court system provides a versatile and adaptable space that can accommodate various sports and activities.

Potential Sports for a Modular Court:



TENNIS

The court can be adjusted to meet the specifications of a tennis court.



HANDBALL

Handball court with handball court lining.

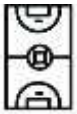

FUTSAL

If the court is configured properly, it can be transformed into a futsal pitch, providing space for indoor soccer matches and training.



INDOOR ARCHERY

The modular court system can be easily configured to accommodate a 15m archery range.



HOCKEY



BOXING/KICKBOXING



MULTI-SPORT EVENTS

The adaptability of the modular court system makes it ideal for hosting multi-sport events where different sports like volleyball and basketball can be played in the same space.

CLIMBING WALL

D BUILDING, FEMALE GYM, LEVEL 2

FACTS

↑
↓ **HEIGHT**
8 meters

←|→ **WIDTH**
Approximately
7 meters

∞ **CLIMBING SURFACE AREA**
Approximately
81 square meters

FEATURES

- Five climbing pathways
- Four Headrush Trublue auto belays
- One rope climbing top anchor



PROPOSED ENHANCEMENTS

Commission the Wall:

1. Conduct a structural survey of the wall.
2. Complete installation.
3. Conduct maintenance.

STUDY PODS

**E BUILDING,
LEVEL 1 AND/OR
LEVEL 3**

CURRENT FACILITIES

Library:

- Provides a quiet environment for individual study.
- Equipped with enclosed spaces for focused work.

Student Hubs:

- Vibrant spaces catering to group study needs.
- Flexible seating arrangements with movable privacy screens.
- While other areas lack enclosed spaces, the Library remains the primary location for focused study.

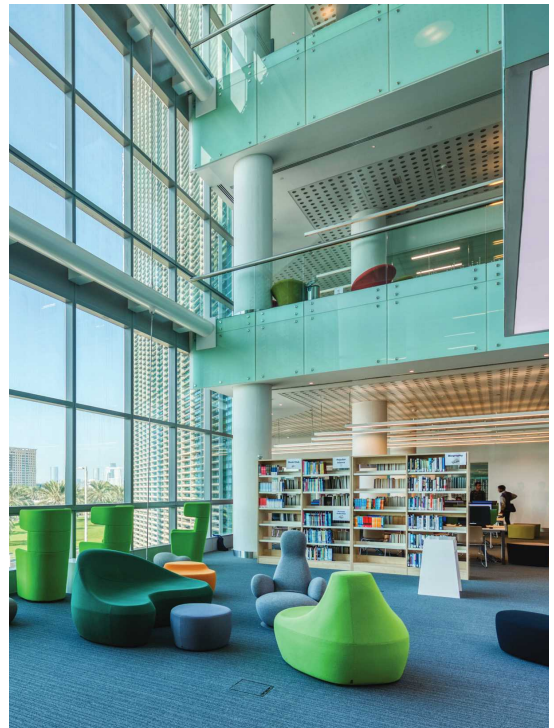

PROPOSED ENHANCEMENTS

A. Study Pods:

Adding Study Pods

- Flexible Capacity (1-6 students).
- Convenient Access.
- Enhanced Environment.
- Mobility.



SAMPLE DESIGN



SAN CAMPUS



CURRENT FACILITIES

- Football Pitches.
- Multipurpose Court.



PROPOSED ENHANCEMENTS

Pitch Renovation

Replace the natural grass with artificial turf grass.

Multipurpose Outdoor Court

Resurfacing of the court.



SAN CAMPUS ADDITIONAL PHOTOS



COSTING

Type of Enhancement	Cost in AED	Note
1. Modular Court System	118,812.5	
2. Floor Replacement	118,812.5	
3. Ceiling Mounted System (Basketball and Scoreboard)	14,250	
4. Partition/Nets	55,000	varies based on actual quality
5. Retractable Bleachers	150,000	varies based on actual quality
6. Padded Wall	150,000	
7. Indoor Track	33,000	varies based on actual quality
8. Martial Arts Space	100,000	based on a commercial proposal submitted in Fall 2022
9. Commission the Wall Climbing	168,000	
10. Artificial Turf Grass – SAN Campus	750,000	varies based on actual quality
11. Court Resurfacing – SAN Campus	100,000	15 Study Pods, 10 for 2 Persons and 5 for 1 Person
12. Study Pods	406,000	

Total **2,163,875.00**

PUBLICITY BENEFITS

Benefits	50% support	100% support
Naming rights of the sports halls (Gym, indoor hall, football field)		☆
1 Joint Press Release		☆
1 Post on Social media	☆	☆
1 Mega KU event as a strategic partner	☆	
2 Mega KU event as a strategic partner		☆
Field booking for various group activities total of (20 hours) in coordination with KU and based on availability	☆	
Field booking for various group activities total of (40 hours) in coordination with KU and based on availability		☆
Internal announcement	☆	☆
Branding opportunity of the field for 1 year	☆	
Branding opportunity of the field for 2 years		☆

Total AED 2,200,000

